

CITY OF LOWELL
MASTER STREET / TRAIL PLAN
ADOPTED, APRIL 16, 2013, ORDINANCE 932

		R-O-W	WIDTH
LOCAL		50'	30'
LOCAL - PROPOSED		50'	30'
MINOR COLLECTOR		50'	30'
MINOR COLLECTOR - PROPOSED		50'	30'
MAJOR COLLECTOR		60'	38'
MAJOR COLLECTOR - PROPOSED		60'	38'
ARTERIAL		100'	62', 68', or 52*'
ARTERIAL - PROPOSED		100'	62', 68', or 52*'
EXPRESSWAY		VARIABLE	
TRAIL			
CITY LIMITS			
PLANNING BOUNDARY			

* 62' with Turning Lane, 68' with Median, 52' with Four Lanes

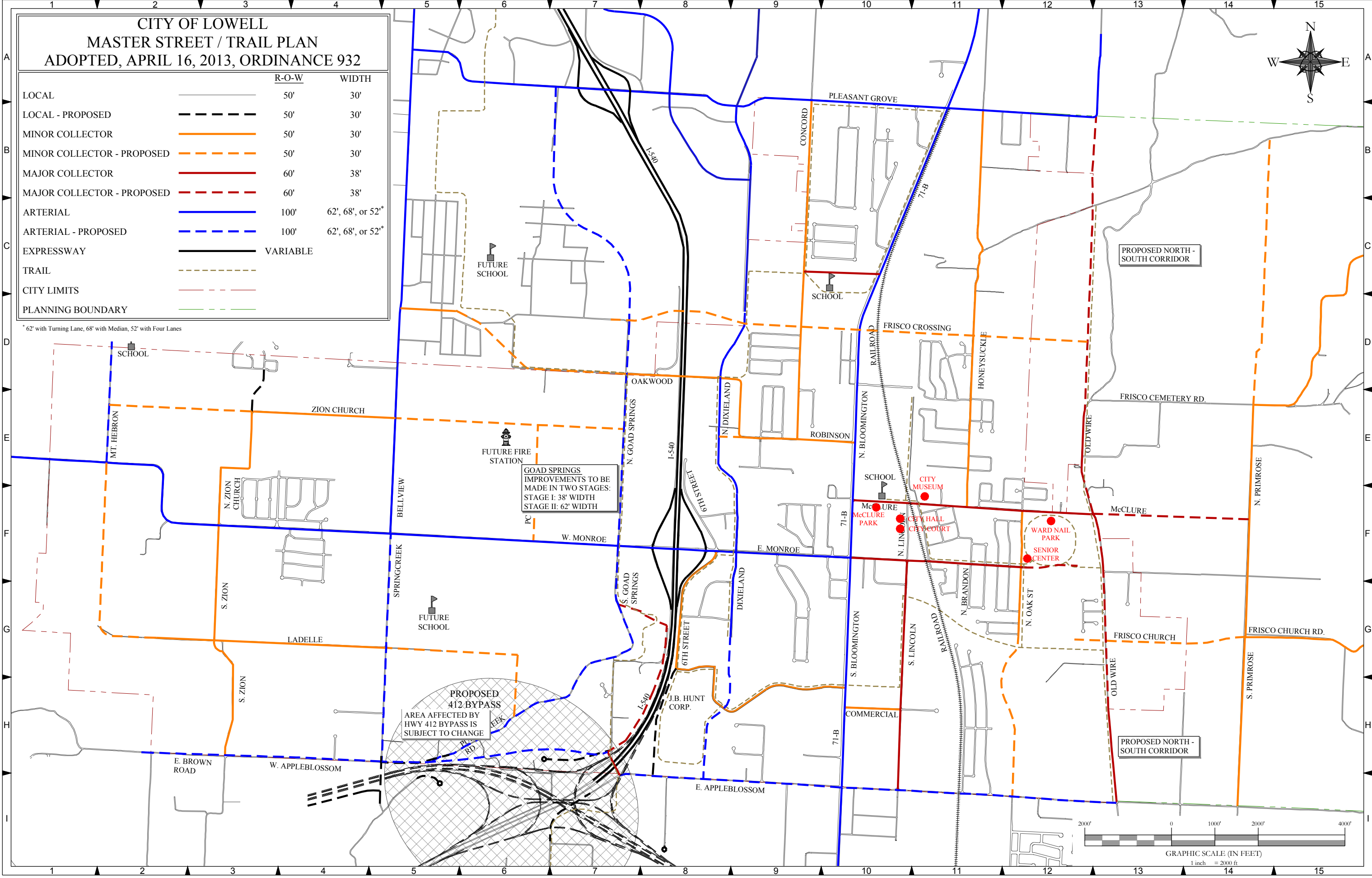
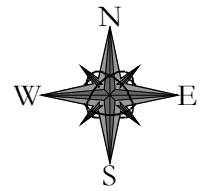

GOAD SPRINGS IMPROVEMENTS TO BE MADE IN TWO STAGES:
 STAGE I: 38' WIDTH
 STAGE II: 62' WIDTH

PROPOSED 412 BYPASS
 AREA AFFECTED BY HWY 412 BYPASS IS SUBJECT TO CHANGE

