

ORDINANCE NO. 1061

**AN ORDINANCE ADOPTING THE CITY OF LOWELL
2020 MASTER STREET PLAN AND FOR OTHER PURPOSES.**

WHEREAS, the rapid growth and the corresponding impact on the roads and other transportation infrastructure in the City of Lowell has led to the need to study and revise the Lowell Master Street Plan, and;

WHEREAS, the City of Lowell Planning Commission has studied the plan, enlisted the help and input of Lowell Community Development, Street Department and other city staff, and has discussed the plan at a public hearing on September 22, 2020, and again on October 20, 2020, for input into the proposed plan and has received and considered valuable input from the public on the Master Street Plan, and;

WHEREAS, after careful study and public input, a final draft was created and the City of Lowell Planning Commission has voted to recommend the adoption of the attached City of Lowell 2020 Master Street Plan, including construction specifications for the various categories of streets contained in the plan, and;

WHEREAS, the Lowell City Council believes that this plan is needed to promote orderly and responsible development in Lowell, and to best protect the safety and enhance the transportation needs of the citizens of Lowell.

NOW, THEREFORE, BE IT ORDAINED BY THE CITY COUNCIL FOR THE CITY OF LOWELL, ARKANSAS:

Section 1. The City of Lowell 2020 Master Street Plan, a true and correct copy of which is attached hereto as Exhibits A is hereby adopted.

Section 2. That all Ordinances or parts of Ordinances in conflict herewith are hereby repealed to the extent of the conflict, and if any portion of this ordinance shall be found to be invalid or illegal for any reason, the remaining portions of this ordinance shall remain in full effect.

PASSED AND APPROVED THIS 20TH day of October 2020.

APPROVED:

ATTEST:

Elizabeth Estes, City Clerk





Chris Moore, Mayor

CITY OF LOWELL 2020 MASTER STREET/TRAIL PLAN

- Expressway
- Expressway On/Off Ramp
- Expressway - Proposed
- Aerial
- Aerial - Proposed
- Collector
- Collector - Proposed
- Local
- Local - Proposed
- Trails
- City Limits

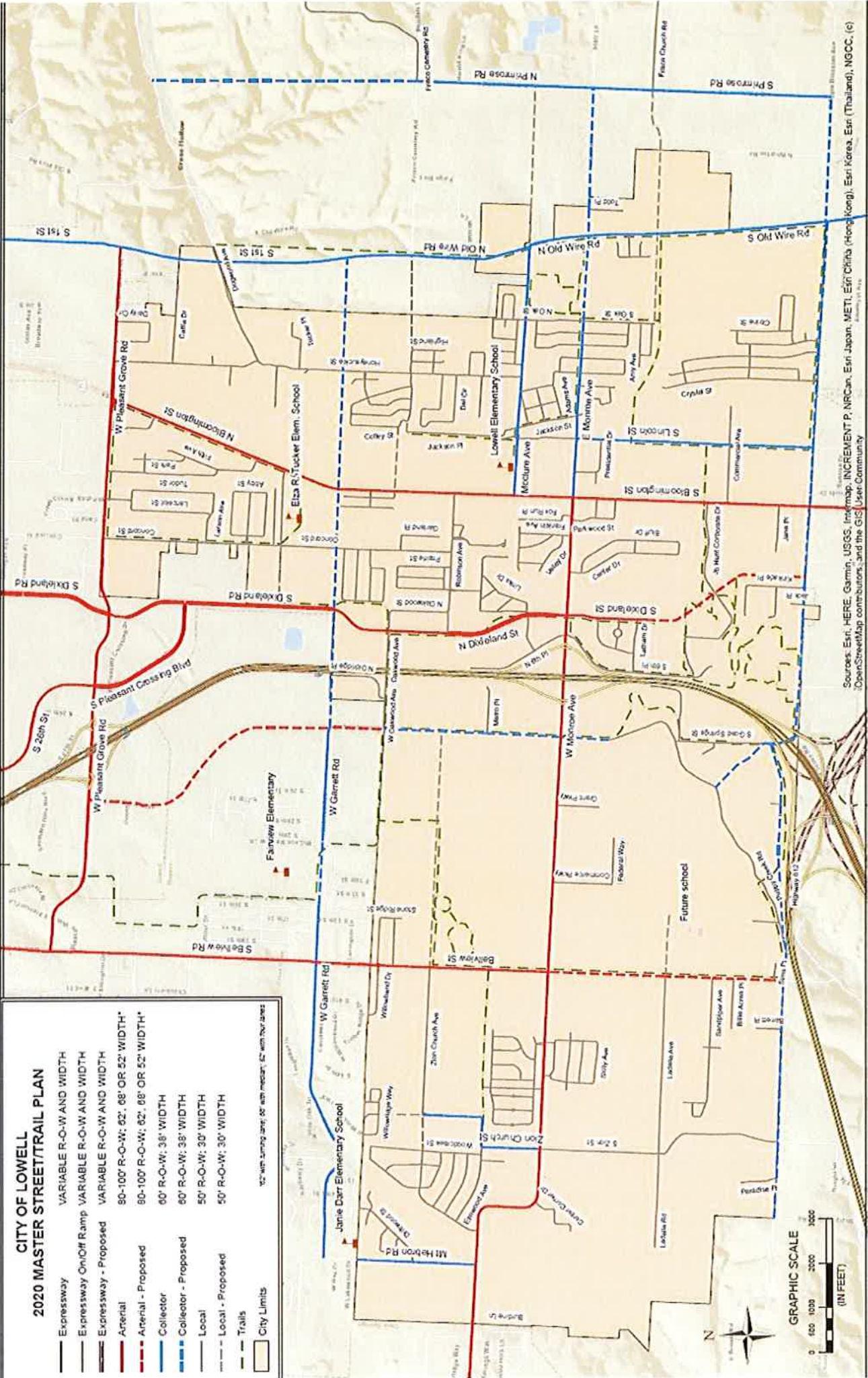
10' with turning lane, 60' with median, 62' with four lanes



Sources: Esri, HERE, Garmin, USGS, Imagery, INCREMENT P, NRCan, Esri Japan, METI, Esri China (Hong Kong), Esri Korea, Esri (Thailand), NGCC, (c) OpenStreetMap contributors, and the GIS User Community