

STANDARD
DETAILS

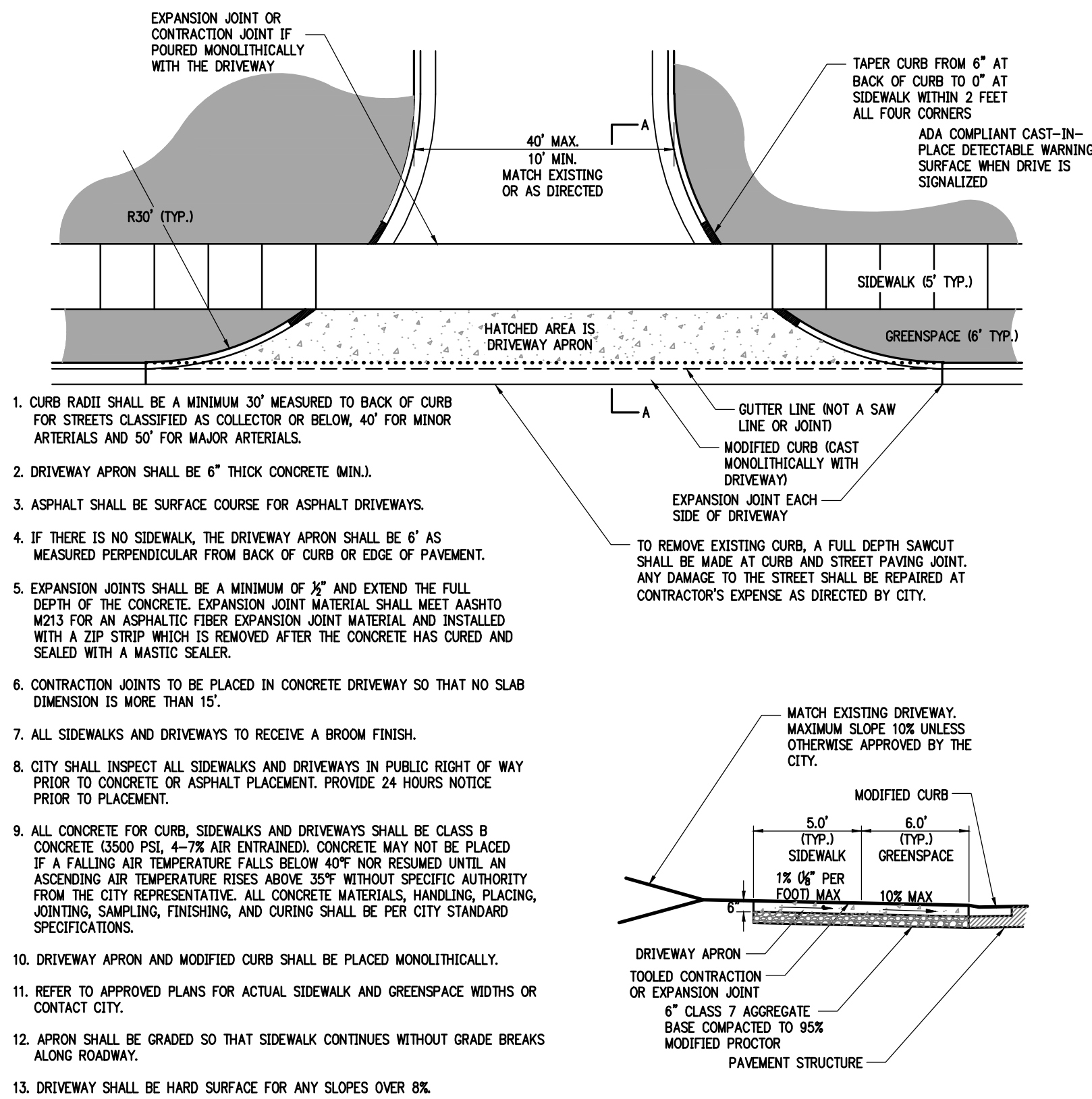

COMMERCIAL DRIVEWAY DETAIL
NOT TO SCALE

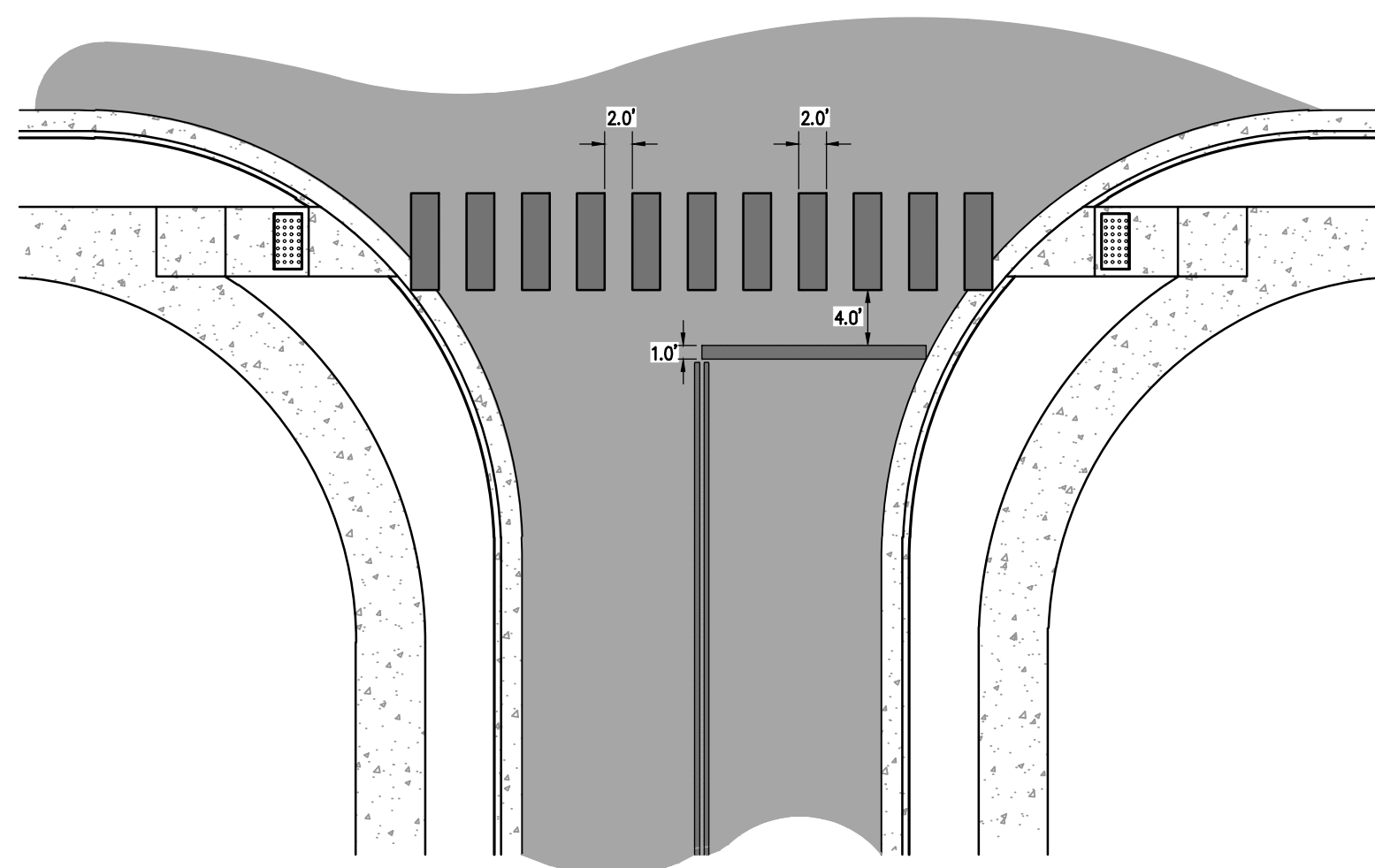

1. WIDTH OF THE CROSSWALK STRIPING SHALL BE THE WIDTH OF THE SIDEWALK PLUS TWO (2) FEET. 1 FOOT EXTRA ON EACH SIDE OF RAMP.
2. CROSSWALK STRIPING SHALL BE CENTERED ON THE ADA RAMP.
3. CROSSWALKS SHALL BE PLACED AT ALL STREET INTERSECTIONS WHERE THERE ARE ADA RAMPS.
4. ALL CROSSWALKS AND STOP BARS SHALL BE WHITE THERMOPLASTIC.
5. CROSSWALKS ARE TO BE INSTALLED PERPENDICULAR TO THE STREET UNLESS APPROVED OTHERWISE BY THE CITY.
6. CROSSWALK PANELS SHALL BE PLACED PARALLEL WITH THE ROAD CENTERLINE.
7. ALL MARKINGS SHALL COMPLY WITH THE CURRENT EDITION OF MUTCD.

TYPICAL CROSSWALK DETAILS
NOT TO SCALE

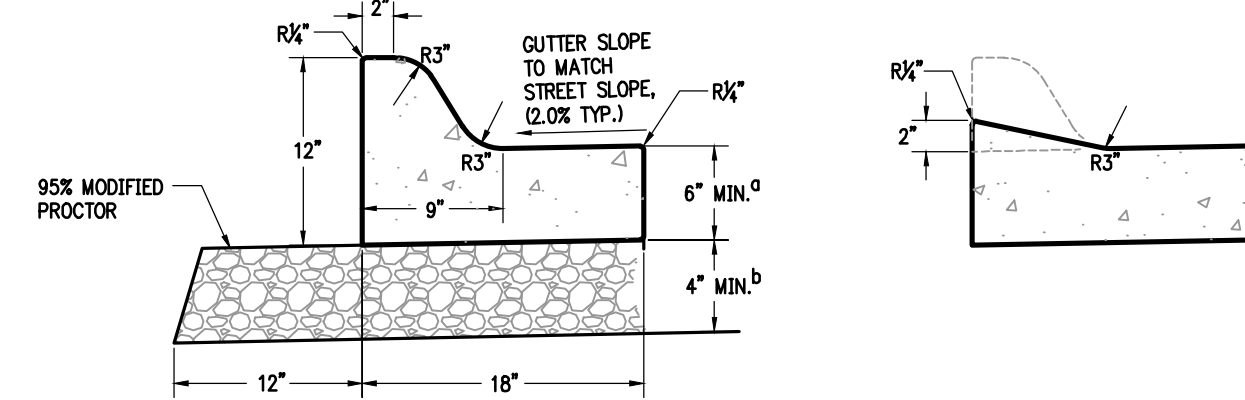

STANDARD CURB AND GUTTER

1. CONCRETE SHALL BE CLASS B, 3500 PSI, 4-7% AIR ENTRAINMENT. CONCRETE MAY NOT BE POURED IF A FALLING AIR TEMPERATURE FALLS BELOW 40°F NOR RESUMED UNTIL AN ASCENDING AIR TEMPERATURE RISES ABOVE 35°F WITHOUT SPECIFIC AUTHORITY FROM THE CITY REPRESENTATIVE. ALL CONCRETE MATERIALS, HANDLING, PLACING, JOINTING, SAMPLING, FINISHING AND CURING SHALL BE PER CITY STANDARD SPECIFICATIONS.
2. CONTRACTION JOINTS SHALL BE PLACED AT 15 FOOT INTERVALS WITH EXPANSION JOINTS AT 75 FOOT INTERVALS.
3. ALL CONTRACTION JOINTS SHALL BE SEALED WITH SONNEBORN SONOLASTIC SLT (OR APPROVED EQUAL) ACCORDING TO MANUFACTURER'S INSTRUCTIONS PRIOR TO FINAL ASPHALT PLACEMENT.
4. EXPANSION JOINT MATERIAL SHALL BE REQUIRED AT ALL STATIONARY STRUCTURES OR AS DIRECTED BY ENGINEER. THE EXPANSION MATERIAL SHALL BE 1/2" ASPHALT IMPREGNATED FIBERBOARD CONFORMING TO AASHTO M-213. MATERIAL SHALL BE LEFT LOWER OR TRIMMED TO BE 1/2" BELOW THE TOP OF CURB.
5. EXPANSION JOINT MATERIAL SHALL BE FULL DEPTH OF THE CURB AND PERPENDICULAR TO THE CURB LINE.
6. ALL CURB AND GUTTER SHALL RECEIVE A BROOM FINISH.
7. CONTRACTOR SHALL PROVIDE THE CITY 24 HOURS NOTICE WHEN FORMS OR STRINGLINE ARE READY PRIOR TO CONCRETE PLACEMENT.
8. FOR CONCRETE STREETS, IF THE CURB AND GUTTER IS CAST SEPARATELY, 1/2" DOWEL RODS 30" LONG SHALL BE PROVIDED A MINIMUM OF EVERY 30' ON-CENTER.

MODIFIED CURB AND GUTTER
(PLACE ACROSS ALL DRIVEWAYS)

- a. IF MONOLITHICALLY CAST WITH THE STREET, THICKNESS SHALL MATCH STREET PAVING THICKNESS.
- b. IF PAVEMENT SECTION IS 10" THICK OR MORE, 4" OF CLASS 7 AGGREGATE SHALL EXTEND UNDER CURB AND 1 FOOT BEYOND. IF THE PAVEMENT SECTION IS LESS THAN 10" THICK, THE CURB AND GUTTER MAY BE PLACED ON SUBGRADE. SUBGRADE SHALL BE PROOF-ROLLED BY A LOADED TANDEM-AXLE DUMP TRUCK.

CURB AND GUTTER DETAIL
NOT TO SCALE

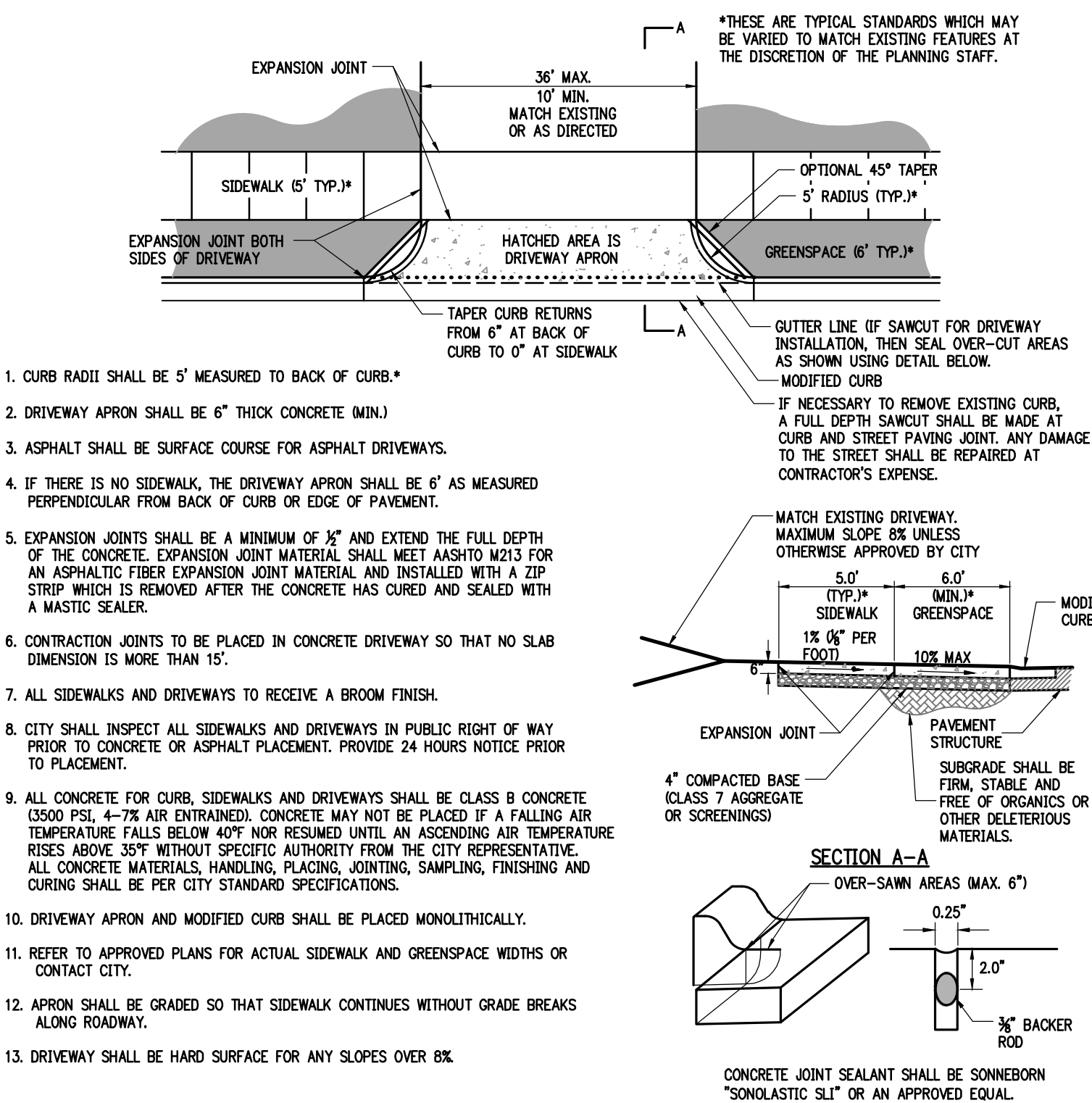

RESIDENTIAL DRIVEWAY DETAIL
NOT TO SCALE

1. ALL CURB RAMPS SHALL HAVE A MAXIMUM SLOPE OF 8.3% BUT SHALL NOT REQUIRE THE RAMP LENGTH TO EXCEED 15.0 FT.
2. ALL SIDEWALKS SHALL HAVE A TARGET CROSS SLOPE OF 1.0%. SEE SIDEWALK DETAILS FOR SIDEWALK CONSTRUCTION REQUIREMENTS. NO PORTION OF ANY SIDEWALK WILL BE ACCEPTED IF THIS CROSS SLOPE EXCEEDS 2.0% OVER ANY 4 FT. WIDE SECTION.
3. CONCRETE SHALL BE 6" THICK AND 3500 PSI WITH 4-7% AIR ENTRAINMENT. 4" OF AGGREGATE BASE SHALL BE REQUIRED BENEATH THE RAMP JUST LIKE THE SIDEWALK. ALL CONCRETE MATERIALS, HANDLING, PLACING, JOINTING, SAMPLING, FINISHING AND CURING SHALL BE PER CITY STANDARD SPECIFICATIONS.
4. DETECTABLE WARNING SURFACES SHALL BE PLACED AT ALL LOCATIONS WHERE RAMPS CROSS A STREET OR A SIGNALIZED COMMERCIAL DRIVEWAY FOR THE FULL WIDTH OF THE RAMP.
5. THE CONTRACTOR SHALL ENSURE THAT THE GUTTER IS MAINTAINED THROUGH THE AREA OF THE RAMP AND THAT ANY TRANSITION AREAS DRAIN TO THE STREET.
6. THE SHADED AREA SHOWN ON THE DETAIL SHALL BE THE PAY LIMITS CONSIDERED AS PART OF THE CURB RAMP.
7. RAMP AND DETECTABLE WARNING SURFACE SHALL BE ORIENTED PERPENDICULAR TO THE DIRECTION OF THE PEDESTRIAN TRAFFIC.
8. THE CURB RAMP WIDTH SHALL MATCH THE SIDEWALK WIDTH.
9. RAMPS SHALL BE MODIFIED AS NECESSARY TO INSURE THAT THEY ARE PARALLEL TO A LINE DRAWN FROM ONE RAMP TO THE CENTER OF THE RAMP ON THE OPPOSITE SIDE OF THE INTERSECTION.
10. PARALLEL CURB RAMPS, BLENDED TRANSITIONS, OR ANY OTHER DEVIATIONS FROM THIS DETAIL WILL REQUIRE SPECIFIC APPROVAL BY THE PLANNING DEPARTMENT.

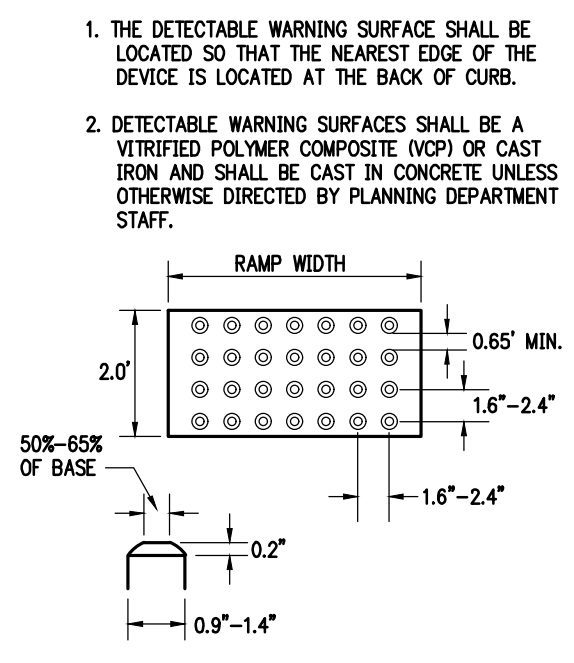

DETECTABLE WARNING SURFACE

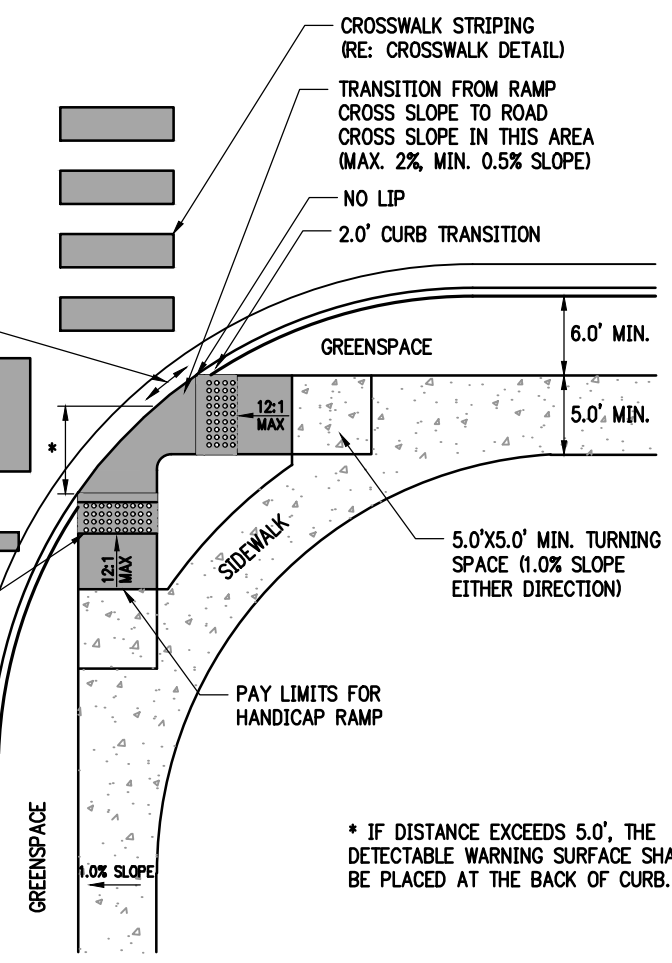
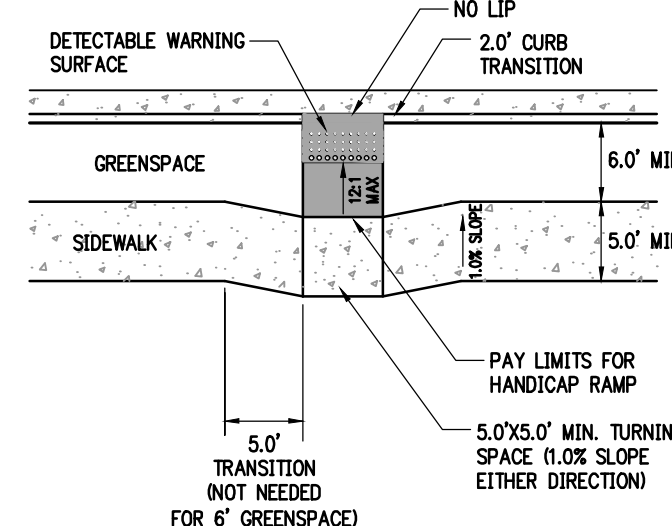

PERPENDICULAR CURB RAMP DETAILS
NOT TO SCALE

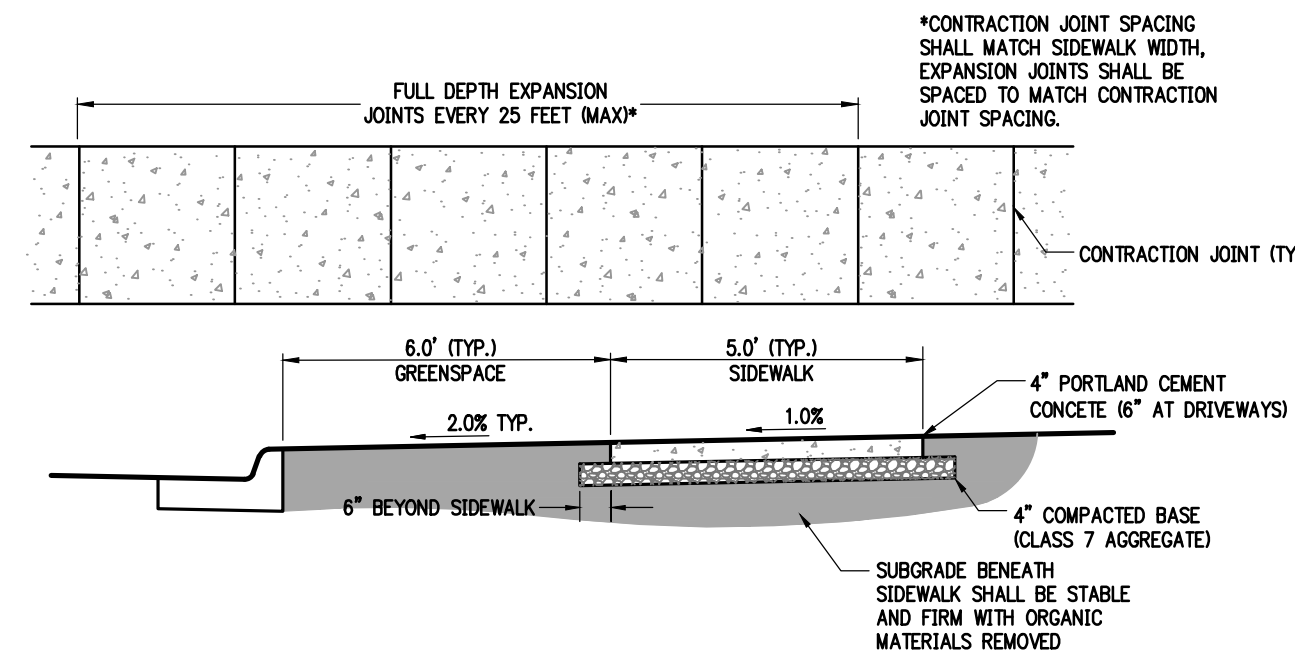

CONNECTION TO
CONCRETE STRUCTURES

1. ALL SIDEWALKS SHALL HAVE A TARGET 1.0% CROSS SLOPE. NO PORTION OF ANY SIDEWALK WILL BE ACCEPTED IF THE CROSS SLOPE EXCEEDS 2.0% OVER ANY 4 FT. WIDE SECTION.
2. ALL SIDEWALKS SHALL RECEIVE A BROOM FINISH.
3. ALL SIDEWALK EDGES SHALL HAVE A 1/2" RADIUS EDGE.
4. ALL CONCRETE SHALL BE CLASS B (3500 PSI, 4-7% AIR ENTRAINMENT). CONCRETE MAY NOT BE PLACED IF A FALLING AIR TEMPERATURE FALLS BELOW 40°F NOR RESUMED UNTIL AN ASCENDING AIR TEMPERATURE RISES ABOVE 35°F WITHOUT SPECIFIC AUTHORITY FROM THE CITY REPRESENTATIVE. ALL CONCRETE MATERIALS, HANDLING, PLACING, JOINTING, SAMPLING, FINISHING AND CURING SHALL BE PER CITY STANDARD SPECIFICATIONS.
5. EXPANSION JOINTS SHALL BE A MINIMUM OF 1/2" AND EXTEND THE FULL DEPTH OF THE CONCRETE. EXPANSION JOINT MATERIAL SHALL MEET AASHTO M213 FOR AN ASPHALTIC FIBER EXPANSION JOINT MATERIAL AND BE INSTALLED WITH A ZIP STRIP WHICH IS REMOVED AFTER THE CONCRETE HAS CURED AND SEALED WITH A MASTIC SEALER.
6. CONTRACTION JOINTS SHALL BE PLACED AT 5 FOOT INTERVALS.*
7. WHEN PLACING SIDEWALK AGAINST AN EXISTING CONCRETE STRUCTURE WHERE IT IS DESIRABLE THAT THE SIDEWALK REMAIN FLUSH, THE SIDEWALK SHALL BE DOWELED INTO THE STRUCTURE.
8. ALL SIDEWALK BASE SHALL BE PLACED ON FIRM, STABLE SUBGRADE.
9. CITY SHALL INSPECT ALL SIDEWALKS IN PUBLIC RIGHT OF WAY PRIOR TO CONCRETE PLACEMENT. PROVIDE 24 HOURS NOTICE PRIOR TO PLACEMENT.
10. CONTACT CITY FOR ACTUAL GREENSPACE AND SIDEWALK WIDTHS REQUIRED PRIOR TO BEGINNING OF CONSTRUCTION. SIDEWALK AND GREENSPACE WIDTH MAY BE VARIED TO MATCH EXISTING FEATURES IF APPROVED BY THE PLANNING STAFF.

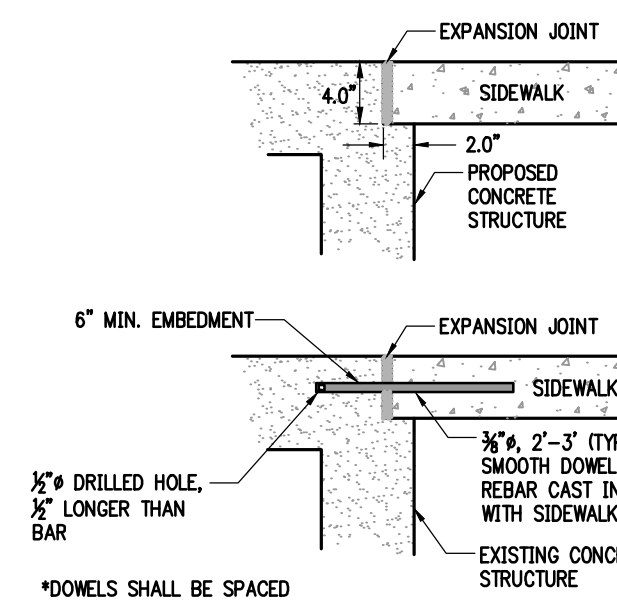

TYPICAL SIDEWALK DETAILS
NOT TO SCALE

Arkansas One Call



Know what's below.
Call before you dig.

REVISIONS:		
No.	Description	Date

NOTES:		

DATE: 02/18/2021

SHEET NUMBER: OF

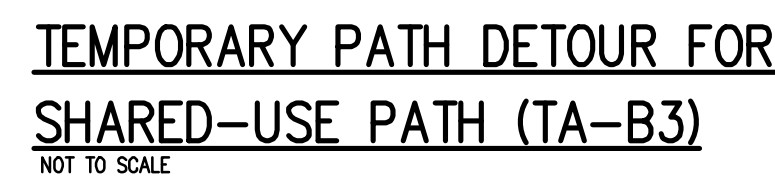

--

[illegible]

NOTES:

DATE: 02/18/2021

SHEET NUMBER:	OF
---------------	----

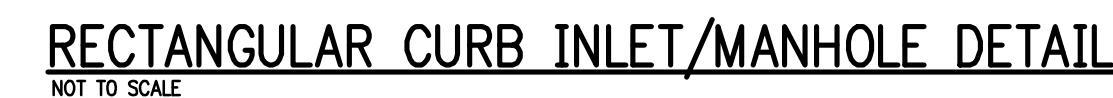
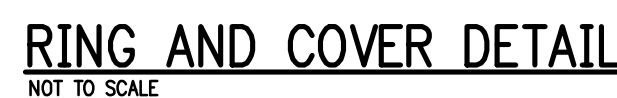

NON-TRAFFIC ONLY